

## Fitting instruction Audi A6 2011 >

UK/US

### **Body**

**Paintwork protection film,  
for scope of delivery**

**4G0.071.316,  
4G0.071.316.A,  
4G0.071.316.B and  
4G0.071.316.C**

Edition 11.2010

## Contents

<b>1</b>	<b>Notes</b> .....	1
1.1	General notes .....	1
1.2	Notes on assembly .....	1
1.3	Maintenance instructions for vehicles with paintwork protection film .....	2
<b>2</b>	<b>Parts overview</b> .....	3
<b>3</b>	<b>Basics for working with adhesive films</b> .....	4
3.1	Preparations – Cleaning the bonding surfaces .....	4
3.2	Applying and fixing the film .....	4
3.3	Correcting problems .....	6
<b>4</b>	<b>Applying films to the vehicle</b> .....	7
4.1	Wing – parts A and B .....	7
4.2	Bonnet – part C .....	7
4.3	Bumper, sides – parts D and E .....	8
4.4	Bumper, bottom side – parts F and G .....	9
4.5	Bumper, bottom centre – part H .....	11
4.6	Headlight washer system covers – parts I, parking aid sensors – parts J and towing eye – part K .....	11
4.7	Concluding operations .....	11

# 1 Notes

## 1.1 General notes

Please read and take note of these WARNING, Caution and Note descriptions before carrying out maintenance or repair work.



### **WARNING!**

***Text with this symbol contains information concerning your safety and indicates potential accident and injury risks.***



### **Caution!**

***Text with this symbol indicates the risk of damage to your vehicle.***



### **Note**

*Text with this symbol contains additional information.*

**AUDI AG will not accept responsibility in the event of failure to comply with these assembly instructions.**

## 1.2 Notes on assembly



### **Caution!**

***Please note the following points:***

- ◆ ***The paintwork protection film system is only suitable for vehicles with paintwork that is no more than six years old. Paintwork repairs performed on used vehicles must conform to AUDI AG specifications.***
- ◆ ***The paintwork protection film system must only be used by certified, skilled personnel or a qualified workshop specialising in film application.***

Properties of the paintwork protection film:

- ◆ UV-resistant
- ◆ Tear-resistant
- ◆ Paintwork protection against stone chips with a diameter less than 0.5 cm



### **Caution!**

***The adhesive on the paintwork protection film requires 72 hours to harden at a minimum temperature of 15 °C. The adhesive will not harden at temperatures below 15 °C.***

- ◆ ***The vehicle may not be driven through a car wash for at least three days after application, following hardening of the adhesive at the appropriate temperatures!***



### **1.3 Maintenance instructions for vehicles with paintwork protection film**

- ◆ The vehicle must be cleaned at least once a month in a car wash to main the protective properties of the film.
- ◆ Insect remains, bird droppings and other aggressive deposits must be removed immediately to help prevent discolouration.
- ◆ Steam jet nozzles must be kept at least 60 cm from the vehicle. Localised pressure may cause the film to lift.

 **Caution!**

***Powder-based or abrasive care and cleaning agents must not be used!***

***The parts of the vehicle with the paintwork protection film must not be polished!***

***Read and observe the notes in the ⇒ Cleaning and care chapter of the vehicle Owner's Manual!***

## 2 Parts overview

The set of films comprises:

- 1 - Paintwork protection films (2x)
- 2 - Cleaning cloth (1x)
- 3 - 5 ml of application concentrate (2x)
- 4 - Scraper (1x)
- 5 - Installation instructions (1x)

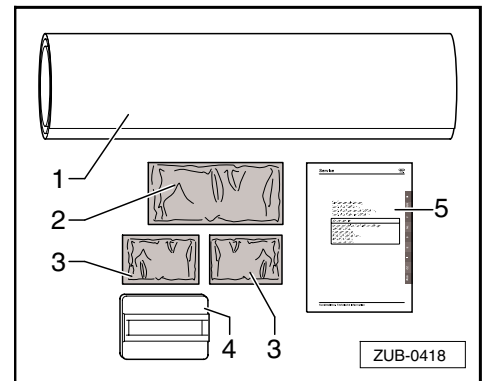

Division of the relevant film sections on the backing paper

- A - Wing, front right
- B - Wing, front left
- C - Bonnet
- D - Bumper, right side
- E - Bumper, left side
- F - Bumper, bottom right side
- G - Bumper, bottom left side
- H - Bumper, bottom centre
- I - Spray nozzle covers for the headlight washer system<sup>1)</sup>
- J - APS sensor recesses (trim for parking aid sender)<sup>1)</sup>
- K - Towing eye cover

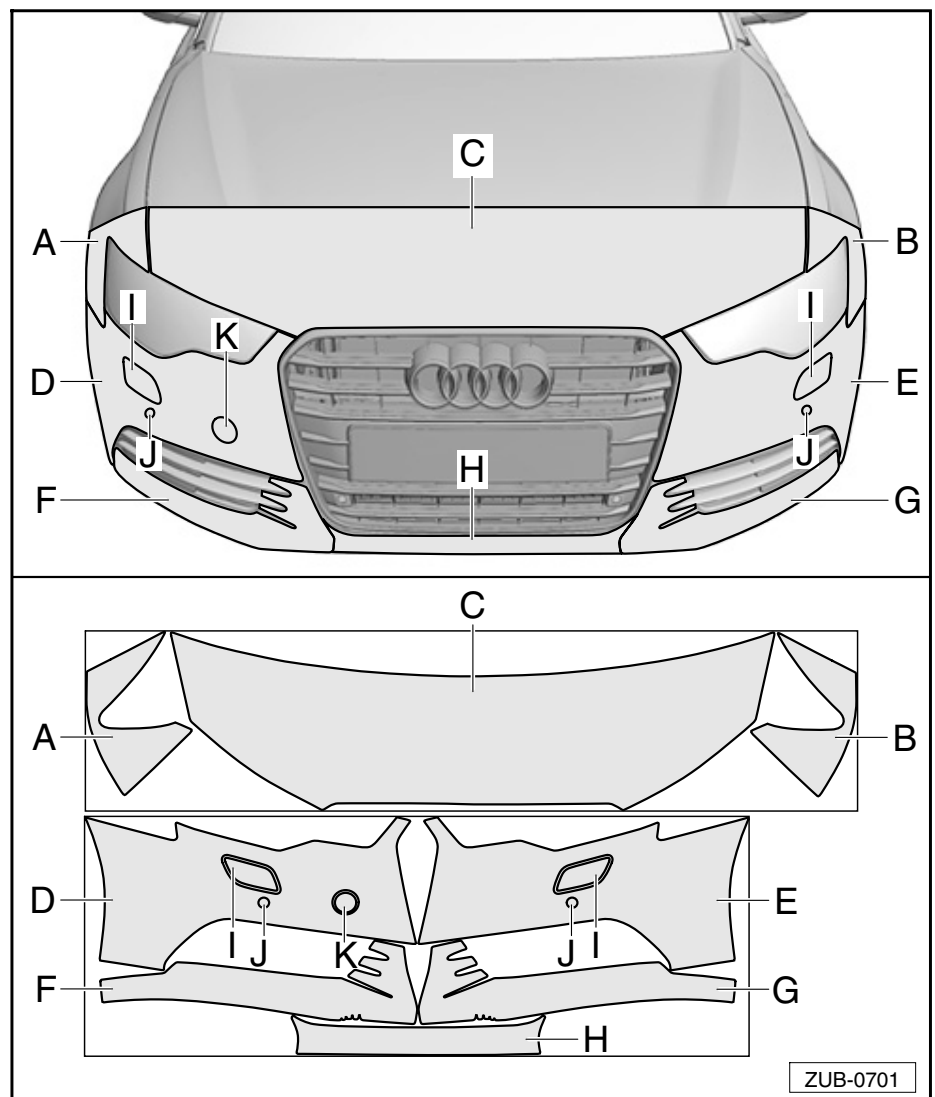

<sup>1)</sup> If available



## 3 Basics for working with adhesive films

### Special tools and workshop equipment required

- ◆ Pump sprayer with application fluid<sup>1)</sup>
- ◆ Cleaning agent<sup>2)</sup>
- ◆ Cleaning cloth (package content)
- ◆ Scraper (package content)

### 3.1 Preparations — Cleaning the bonding surfaces

- The vehicle must not have nano sealing.
- Clean application areas thoroughly (including edges, seams and gaps) as dirt can be rinsed out during “wet application” in particular. Do not use wax or similar additives.



#### Note

*Remove the air intake grilles to thoroughly clean the area above the bottom films and allow it to dry. This prevents dirty water from entering the bonding area.*

- Dry the mounting surfaces.
- Remove any labels and adhesive residue.
- Remove insect remains using insect cleaner -00A.096.300-.
- Remove any wax residue or similar sealing agents using active foam cleaner -00A.096.301-.
- If necessary, repair damaged paintwork (note the drying period).
- Thoroughly remove any oil or grease from the application surfaces using the cleaning cloth provided. To protect the films during application, wrap the scraper in the cleaning cloth.
- Let the mounting surfaces air dry for five minutes.



#### Note

*The film will not adhere to nano sealing, wax or similar sealing agents.*

### 3.2 Applying and fixing the film

- Working temperature 15 to 30° C.
- No direct sunlight (the vehicle must not absorb any heat from the sun).

---

<sup>1)</sup> Application fluid made up of one litre of water and the application concentrate provided.

<sup>2)</sup> Remove insect remains using insect cleaner -00A.096.300- and wax residue or similar sealing agents with active foam cleaner -00A.096.301-.

- The film backing paper should remain in place until immediately prior to application.
- During application, make sure that the film does not dry out on areas that are still to be processed.

**i Note**

- ◆ *The film may be statically charged when the paper backing is removed.*
- ◆ *Clothing with loose fibres such as woollen jumpers etc. should not be worn when applying the films.*
- ◆ *Long, loose hair must be tied back or covered with a cap.*
- Clean the bonding surfaces on the vehicle  
 ⇒ “3.1 Preparations – Cleaning the bonding surfaces” on page 4.
- Use a pump sprayer to spray the application fluid onto the bonding surfaces on the vehicle.
- Spray hands and fingers with application fluid.
- Remove the film from the backing paper.
- Spray the bonding surfaces of the film liberally with application fluid.

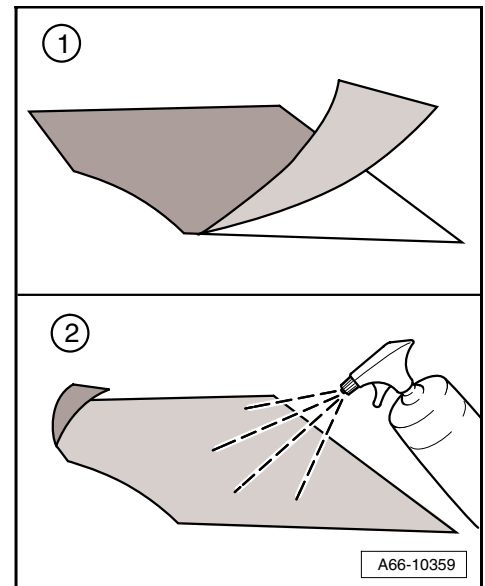

- Apply the film and push/pull into position (stretch if necessary) so that the distance from the film to the vehicle body edges -1- is 2 to 3 mm.

**i Note**

- ◆ *Rounded surfaces of the vehicle body require that the film be pulled (stretched) into position in certain areas.*
- ◆ *The position of each film can be adjusted long after application.*
- ◆ *If a film will no longer move, remove it, re-spray with a liberal amount of application fluid and reposition.*
- Wrap the scraper in the cleaning cloth provided.
- Spray the film with application fluid.

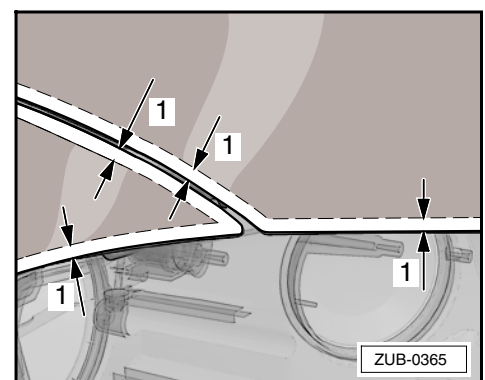

- Starting from a fixed point or the centre of the film, use the scraper to squeeze out the water and any air bubbles from underneath the film.

 **Caution!**

- **Always wrap the scraper in the cleaning cloth provided. If the scraper is used without the cleaning cloth, the film may be scratched.**
- **Always smooth longitudinal films from the middle to the “nearest” edge – if films are smoothed towards the “furthest” edge, they may stretch (longitudinal stretching – fitting problems).**

### 3.3 Correcting problems

- In the event of “blistering”, press down on the raised area of film for approximately one minute. The adhesive on the film will be activated by the warmth of your hand.

 **Note**

*Any small water bubbles that are still visible after completion will disappear over time.*

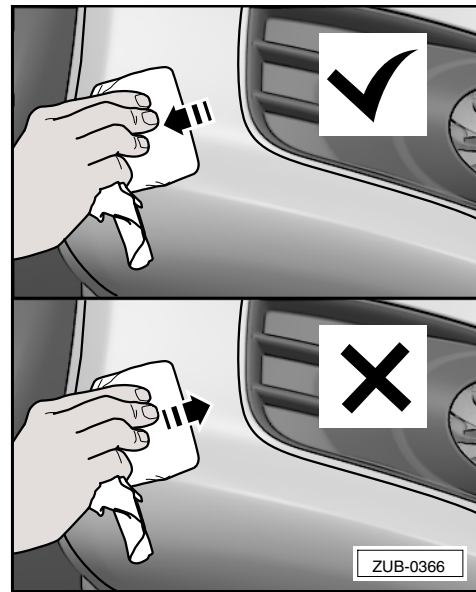



## 4 Applying films to the vehicle

- Bonding surfaces cleaned ⇒ “3.1 Preparations – Cleaning the bonding surfaces” on page 4.

### 4.1 Wing — parts A and B

- Spray the application area on the wing with application fluid.
- Remove the film -A- from the backing paper and spray it with application fluid.
- Place the film on the wing, align it with the edges of the body in the areas marked -1- and -2- (2 to 3 mm); smooth out (in the direction indicated by the arrow) in the area marked -3-.
- Continue to align the film with the edges of the body in the areas marked -2- and smooth out (in the direction indicated by the arrow) in the area marked -4-.
- Disregard the area marked -7- (depression below the swage line) during this process.
- Align the film with the edges of the body in the areas marked -2- and -5- and smooth out (in the direction indicated by the arrow) in the area marked -6-.
- Smooth out the film in the area marked -7-.
- Apply the film -B- to the opposite side of the vehicle following the same procedure.

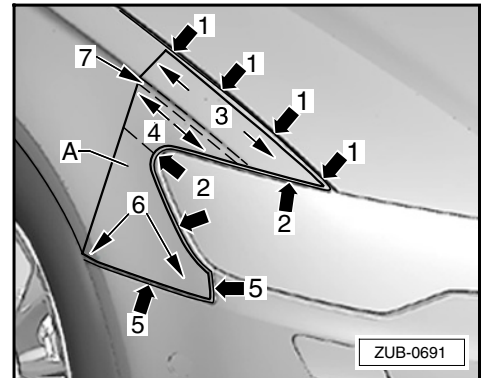

UKI/US

### 4.2 Bonnet — part C

- Spray the bonnet application area for the film -C- liberally with application fluid.
- Remove the film for the bonnet -C- from the backing paper, spray it with application fluid and place it on the application area.
- Align the film with the tips of the bonnet in the areas marked -1- and the front bonnet edge in the areas marked -2-.

#### Note

*When positioning the film, the warmth of your hands will activate the adhesive and make the film easier to position.*

- Smooth out the film (in the direction indicated by the arrow) in the area marked -3-, making sure that it is positioned correctly at the front bonnet edge in the area marked -2-.

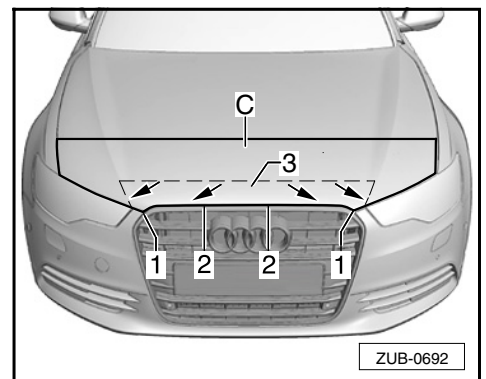

- Align the film with points -1- and -2- on the side edge of the bonnet by pulling it gently; secure lightly in place.
- Smooth out the film (in the direction indicated by the arrow) in the area marked -3-.
- Smooth out the film (in the direction indicated by the arrow) in the area marked -4-.
- Apply the film to the opposite side of the vehicle following the same procedure.

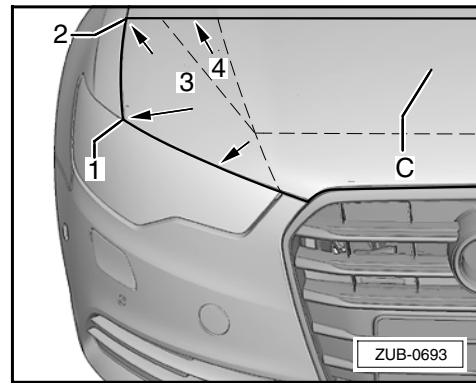

- Then smooth out the film (in the direction indicated by the arrow) in the areas marked -1 to 3-, observing the sequence indicated. Make sure that the "excess film" is distributed evenly.

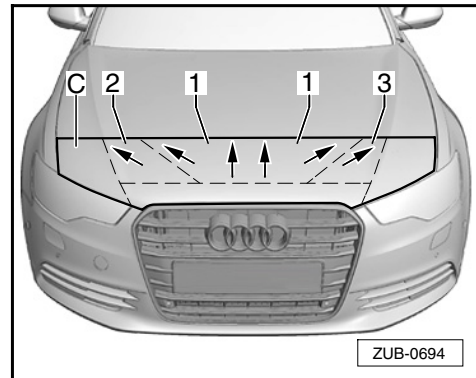

### 4.3 Bumper, sides — parts D and E

- Spray the bumper application area for film -D- liberally with application fluid.
- Remove the film for the bumper, side, -D- from the backing paper, spray it with application fluid and place it on the application area.

 **Note**

*When positioning the film, the warmth of your hands will activate the adhesive and make the film easier to position.*

#### Models with headlight washer system

- Align the film with the cover for the headlight washer system -I- and push it into position using the palms of your hands.
- Smooth out the film to cover a distance of approximately 2 cm around the cover for the headlight washer system -I-.

#### Models without headlight washer system

- Align the film with the bumper edges and push it into position using the palms of your hands.
- Smooth out the film in the area marked -1-.

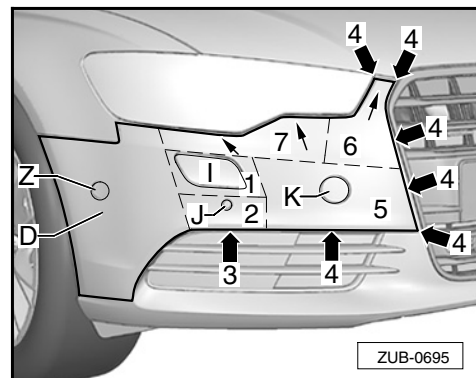

### Models with parking aid sensor

- Align the film with the parking aid sensor -J- and the edge marked -3-.
- Smooth out the film in the area marked -2-.

### Models without parking aid sensor

- Align the film with the edge marked -3- and smooth out in the area marked -2-.

### Continue for all vehicles

- Align the film with the towing eye recess -K- and the edges marked -4-.
- Smooth out the film in the area marked -5-.
- Continue to align the film with the edges marked -4- and smooth out (in the direction indicated by the arrow) in the area marked -6-.
- Align the film with the headlight and smooth out (in the direction indicated by the arrow) in the area marked -7-.
- Using the palms of your hands, gently push the film to align it with the edge marked -1-; secure lightly in place.
- Align the film parallel to the edge marked -2- and smooth out (in the direction indicated by the arrow) in the area marked -3-.
- Smooth out the film (in the direction indicated by the arrow) in the area marked -4-.

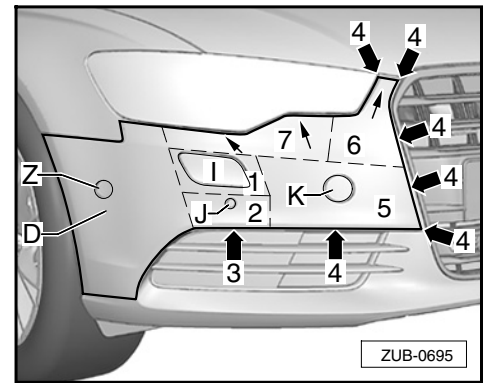

### Vehicles with "Audi parking aid"

#### **Caution!**

**Take care not to damage the vehicle when cutting out the section of film.**

- Cut out the film in the area marked -Z-.

### All vehicles

- Apply the film -E- to the opposite side of the vehicle following the same procedure.

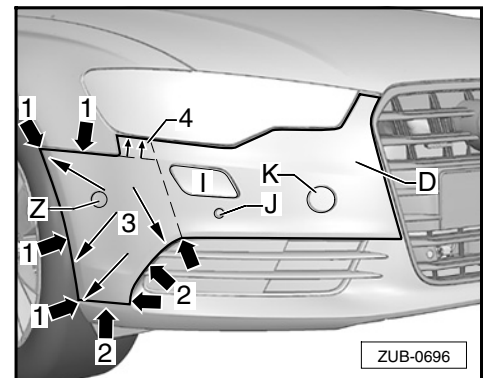

## 4.4 Bumper, bottom side — parts F and G

- Spray the bumper application area for film -F- liberally with application fluid.
- Remove the film for the bottom side of the bumper -F- from the backing paper, spray it with application fluid and place it on the application area.
- Align the film with the "lugs" -1- and the edges marked -2- and push into position using the palms of your hands.
- Smooth out the film in the area marked -3-, making sure that there is no tension and that the film is positioned correctly around the "lugs" -1-.

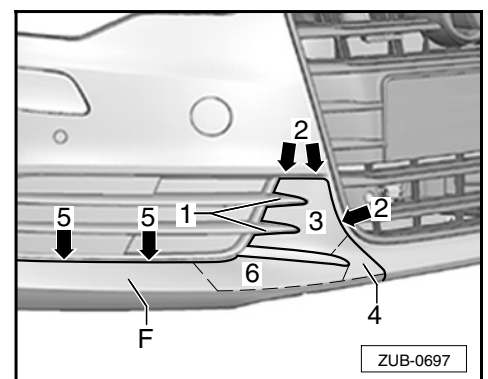

- Smooth out the film in the area marked -4-, making sure that there is no tension.
- Align the film parallel to the edge marked -5-.
- Smooth out the film in the area marked -6-.
- Using the palms of your hands, gently push the film to align it with the wheel housing -1- and the edges marked -2-. Make sure that the film -F- is aligned parallel to the film -D- with a gap of approx. 1 to 2 mm -arrow 3-; secure lightly in place.

 **Caution!**

**Do not overstretch the film when pulling it.**

 **Note**

*When positioning the film, the warmth of your hands will activate the adhesive and make the film easier to position.*

- Gently pull the film outwards from the lower edge in the area marked -7- and align the film parallel to the edge marked -4-.
- Smooth out the film parallel to the air intake grille (in the direction indicated by the arrow) in the area marked -5-.
- Make sure that the film is positioned correctly at the edge marked -2-.
- Check that the film is positioned correctly at the edges marked -1- and -3-; correct if necessary and smooth out (in the direction indicated by the arrow) in the area marked -6-.
- Smooth out the film downwards in the area marked -7-.
- Smooth out the film downwards in the area marked -1- and make sure that the teeth -2- are positioned correctly.

 **Note**

*The teeth are easier to smooth out when the film has dried slightly in this position.*

- Apply the film -G- to the opposite side of the vehicle following the same procedure.

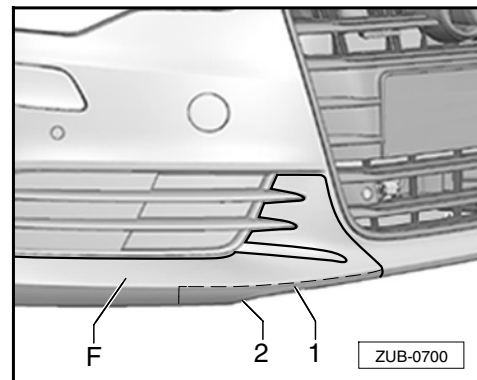
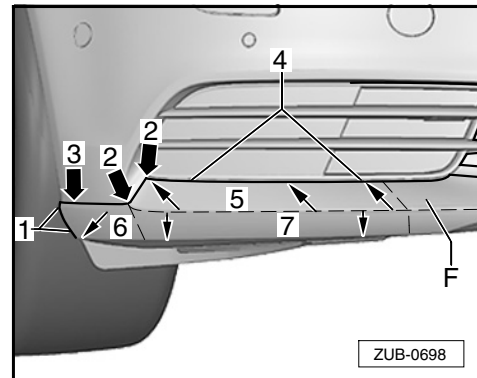

## 4.5 Bumper, bottom centre — part H

- Spray the bumper application area for film -F- liberally with application fluid.
- Remove the film for the bottom centre bumper -H- from the backing paper, spray it with application fluid and place it on the application area.
- Align the fold in the film with the edge -arrow 1- at the left and right.
- Align the film on the left and right -arrows 2- parallel to the films -F- and -G-. Retain a gap of approx. 1 to 2 cm and make sure that the film is positioned correctly at the edge marked -3-.
- Starting from the centre, smooth out the film (in the direction indicated by the arrow) in the area marked -4-, making sure that the film is positioned correctly at the edge marked -3-.
- Starting from the centre, smooth out the film (in the direction indicated by the arrow) in the area marked -5-.
- Starting from the centre, smooth out the film (in the direction indicated by the arrow) in the area marked -6-.

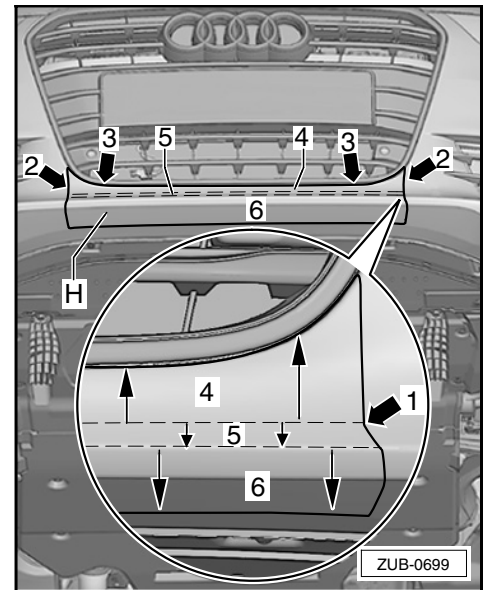

UKI/US

## 4.6 Headlight washer system covers — parts I, parking aid sensors — parts J and towing eye — part K

- If required, apply the films marked -I-, -J- and -K-  
 ⇒ “2 Parts overview” on page 3.

## 4.7 Concluding operations

- Include this booklet with the vehicle Owner's manual.
- When returning the vehicle, advise the customer of the hardening time for the paintwork protection film and the necessary maintenance requirements ⇒ page 2.